

NOTE
 WHEN RECONSTRUCTING THE FOOTPATH THE LEVELS MUST MATCH EXISTING OR BE IN ACCORDANCE WITH THE APPROVED LEVELS IN THE DEVELOPMENT CONSENT. THE MINIMUM EXTENT OF FOOTPATH TO BE RECONSTRUCTED TO BE APPROVED BY THE COUNCIL DELEGATE PRIOR TO WORKS STARTING. ACHIEVE A LONGITUDINAL FALL TO SUIT EXISTING AND NO GREATER THAN 1 IN 20 AND CROSS FALL OF 2% AWAY FROM PROPERTY BOUNDARIES. SEEK GUIDANCE FROM COUNCIL FOR FALLS OUTSIDE OF THIS RANGE.

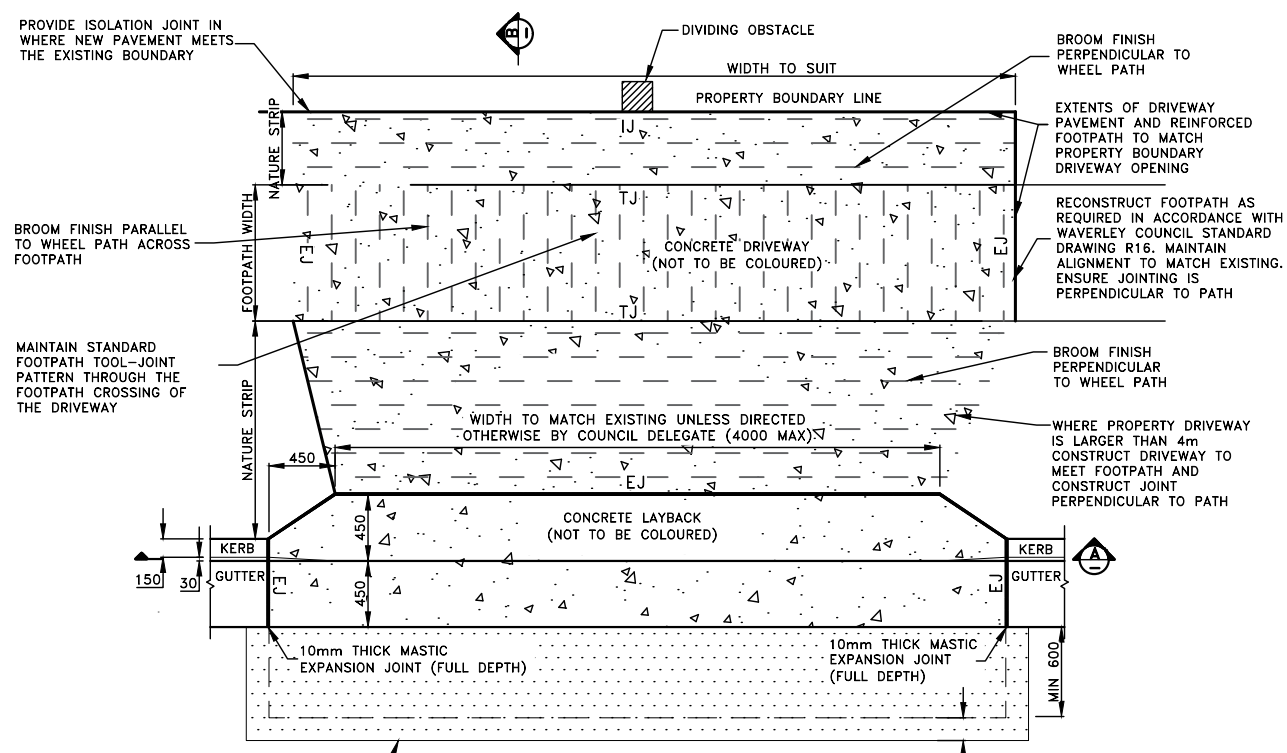

PLAN
 NOT TO SCALE

LEGEND

TJ	TOOL JOINT
EJ	EXPANSION JOINT
IJ	ISOLATION JOINT

SAWCUT, REMOVE AND REINSTATE PAVEMENT MIN 600mm WIDTH DEEPLIFT PAVEMENT AND A FURTHER 150mm WIDTH AC10 WEARING COARSE RE-SHEET WITH MATCHING COLOUR LIQUID CRACK SEALANT, OR AS DIRECTED BY COUNCIL DELEGATE. REFER TO STANDARD DRAWING R6 FOR FURTHER DETAIL.

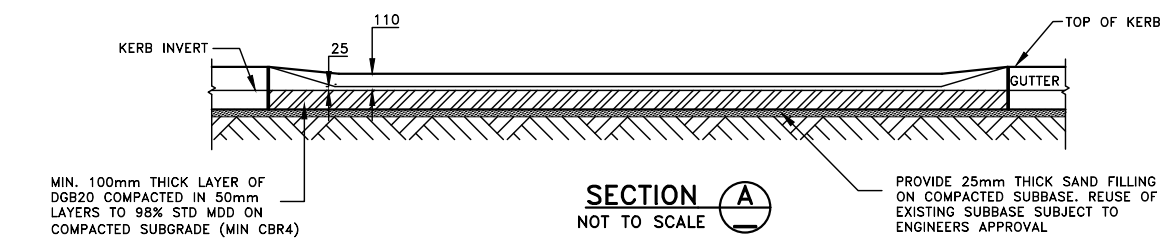

SECTION A
 NOT TO SCALE

NOTE
 ANY CONSTRUCTION WITHIN THE PUBLIC DOMAIN REQUIRES COUNCIL APPROVAL. NON-APPROVED WORKS AND STRUCTURES MAY BE REQUIRED TO BE REMOVED AND THE EXISTING REINSTATED AT THE CONTRACTORS OR DEVELOPERS COST.

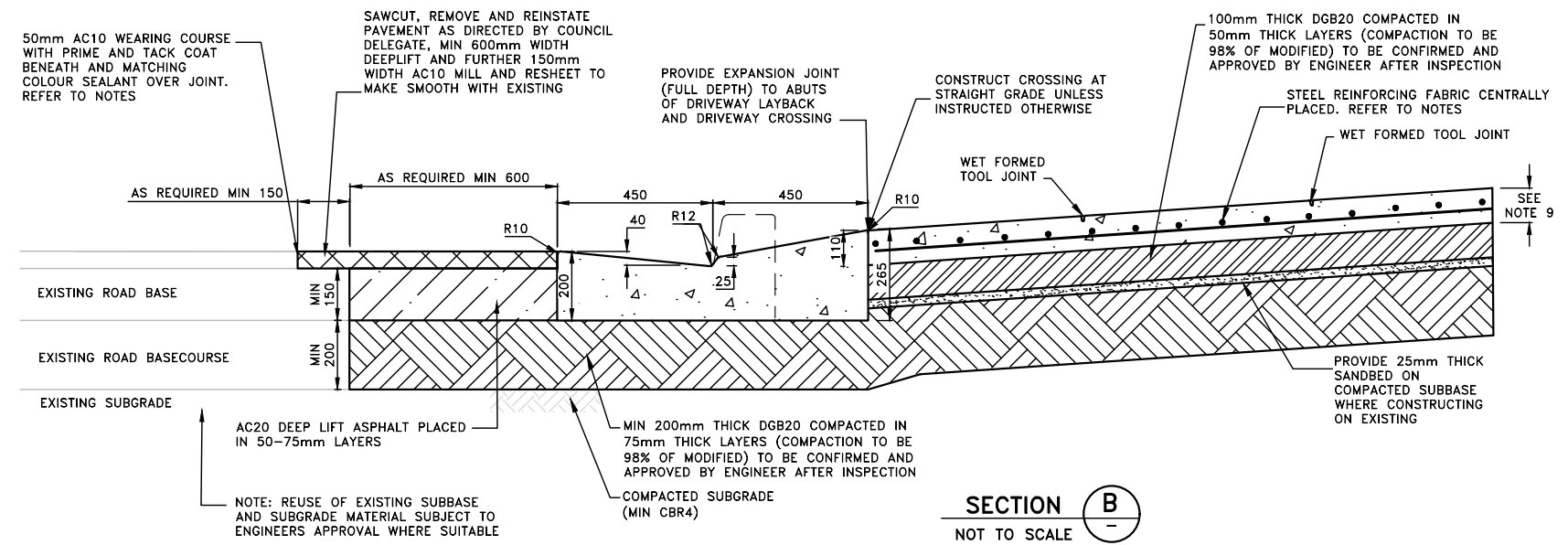

SECTION B
 NOT TO SCALE

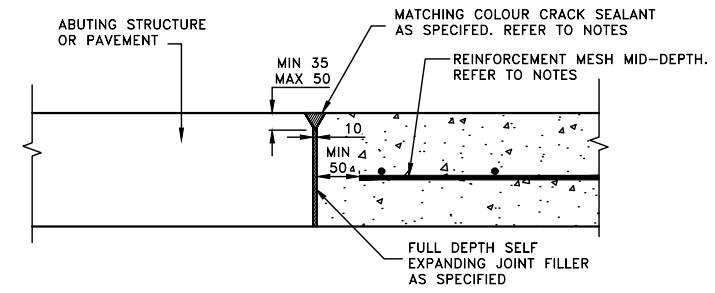

TYPICAL ISOLATION JOINT (IJ)
 NOT TO SCALE

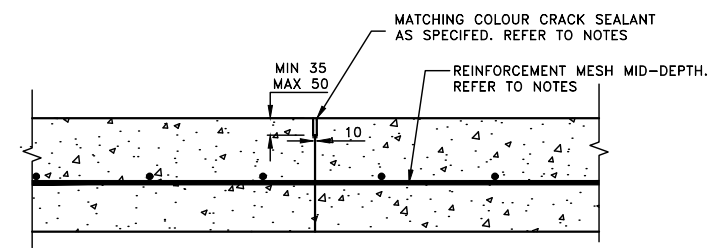

TYPICAL TOOL JOINT (TJ)
 NOT TO SCALE

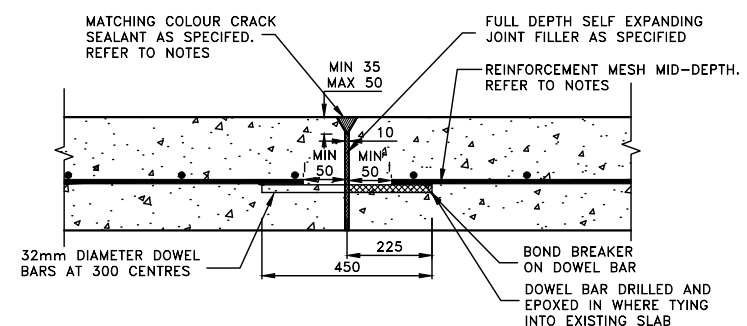

TYPICAL EXPANSION JOINT (EJ)
 NOT TO SCALE

NOTES

- THE WORKS SHALL COMPLY WITH THE CURRENT AND RELEVANT AUSTRALIAN STANDARDS AND TNSW TECHNICAL DIRECTIONS AND GUIDELINES, UNLESS INSTRUCTED OTHERWISE BY THE COUNCIL DELEGATE.
 - DESIGN AND CONSTRUCTION OF WORKS INCLUDING KERBS, GUTTERS, VEHICULAR CROSSINGS, KERB RAMPS, STORMWATER INFRASTRUCTURE, AND THE LIKE, ON STATE ROADS TO BE APPROVED BY TNSW AND TO THE SATISFACTION OF THE COUNCIL DELEGATE.
 - ROAD BASE TO BE EXTENDED BENEATH KERBS, GUTTERS, APRONS AND DISH CROSSINGS. 150mm THICK RECYCLED COMPACTED DGB20 OR 150mm THICK LEAN MIX CONCRETE, COMPACTED TO 98% S.D.D.
 - CONCRETE TO BE OF 32MPa COMPRESSIVE STRENGTH AT 28 DAYS FOR KERBING AND GUTTERING, LAYBACKS, VEHICULAR CROSSINGS AND MISCELLANEOUS KERBING AND EDGE STRIP.
 - ALL EDGES SHALL BE TOOL FINISHED WITH 12mm RADIUS 50mm WIDE EDGING TOOL.
 - CONCRETE FINISH FOR KERBS, GUTTERS, APRONS AND CROSSINGS TO BE STEEL TROWEL.
 - PROVIDE EXPANSION JOINTS FOR FOOTPATH PAVEMENT AS APPROPRIATE BUT SPACED NOT MORE THAN 6m AND TOOL JOINTS EVERY 1.5m, OR AS SPECIFIED. JOINTS SHALL BE STRAIGHT, CONTINUOUS AND NORMAL TO BOUNDARIES AND EDGES. PROVIDE FULL DEPTH EXPANSION JOINTS TO BOUNDARIES, STRUCTURES, KERBS, EDGES AND THE LIKE.
 - PROPERTY STORMWATER OUTLET TO BE 125x75x4 RHS, OR TO SUIT EXISTING, MAINTAINING GRAVITY TO FALL TO K&G. INVERT OF OUTLET TO BE LEVEL WITH INVERT OF GUTTER AND MIN 200mm FROM END OF DRIVEWAY OR KERB RAMP LAYBACK.
 - CLASS A (L/D) RESIDENTIAL DRIVEWAYS 100mm THICK / SL72 MESH
 -CLASS B (H/D) MEDIUM DENSITY (VILLAS/TOWNHOUSES) 150mm THICK / SL82 MESH
 -CLASS C COMMERCIAL & INDUSTRIAL 200mm THICK / SL102 MESH
 - LEVEL AT BUILDING ALIGNMENT IS TO COMPLY WITH LEVELS ISSUED IN THE DEVELOPMENT CONSENT, UNLESS OTHERWISE STATED BY THE COUNCIL DELEGATE.
 - LEVELS FOR REINSTATEMENT WORKS TO MATCH EXISTING, UNLESS INSTRUCTED OTHERWISE BY THE COUNCIL DELEGATE.
 - THE CONCRETE IS TO USE TYPE A PORTLAND CEMENT AND IS NOT TO BE ARTIFICIALLY COLOURED, STENCILLED, STAMPED OR PATTERNED.
 - ALL REINFORCEMENT TO BE HOT DIP GALVANISED TO AS4671 WITH MINIMUM 50 COVER.
 - RE-SHEET MINIMUM 600mm WIDTH OF DEEP LIFT PAVEMENT AND A FURTHER 150mm WIDTH OF AC10 WEARING COARSE ADJACENT NEW KERB, GUTTER, DISH CROSSINGS OR LAYBACKS. REFER TO STANDARD DETAIL R6 FOR FURTHER DETAIL.
 - EXCAVATION ON PAVEMENTS SHALL BE FROM EXISTING JOINTS WHERE AVAILABLE OR OTHERWISE SHALL BE SAWN ALONG ALL EDGES.
 - CONTRACTOR TO OBTAIN & LOCATE ALL SERVICES PRIOR TO WORKS COMMENCING. UTILITY SERVICE COVERS ARE TO BE ADJUSTED TO SUIT DESIGN FINISHED SURFACE LEVELS. UTILITY COVERS TO BE CLASS D OR EQUIVALENT, OR AS SPECIFIED BY UTILITY ASSET OWNER.
 - COUNCIL'S DELEGATE TO INSPECT FOR ALL UNSOUND AREAS BEFORE PROFILING AC PAVEMENT AND AFTER PROOF ROLLING. WEAK SECTIONS ARE TO BE IDENTIFIED AND HEAVY-PATCHED TO A NOMINAL THICKNESS OF 150mm WITH AC28 BEFORE RESEALING IN ACCORDANCE TO TYPICAL CROSS-SECTION.
 - UNLESS SPECIFIED, OVERLAY TO CONSIST OF 50mm THICK AC10.
 - UNLESS SPECIFIED, CRACK SEALANT FOR FLEXIBLE PAVEMENT TO BE BITULASTIC BITUFLEX OR APPROVED EQUIVALENT.
 - UNLESS SPECIFIED, CRACK SEALANT FOR RIGID PAVEMENT TO BE "DOW CORNING 888" OR APPROVED EQUIVALENT.
 - INSPECTIONS ARE REQUIRED AT THE FOLLOWING STAGES AND AS OTHERWISE DIRECTED BY THE COUNCIL DELEGATE. DO NOT CONTINUE UNTIL APPROVAL RECEIVED FROM COUNCIL DELEGATE.
- ROAD PAVEMENT**
- SUBGRADE TRIMMED AND CONSOLIDATED PRIOR TO FIRST PAVEMENT COURSE. (NOTE: SINGLE AXLE TRUCK WITH 8t LOAD TO BE AVAILABLE FOR PAVEMENT TEST).
 - EACH PAVEMENT LAYER SPREAD AND COMPACTED. (NOTE: SINGLE AXLE TRUCK WITH 8t LOAD TO BE AVAILABLE FOR PAVEMENT TEST).
 - PAVEMENT COMPLETED PRIOR TO SEALING.
- CONCRETE WORKS**
- SUBGRADE TRIMMED AND CONSOLIDATED.
 - EXCAVATION COMPLETED, FORMWORK AND REINFORCEMENT SET.
 - CONCRETE FORMED AND CURED.
- RECONSTRUCT FOOTPATH EACH SIDE OF DRIVEWAY TO MATCH EXISTING LEVELS, UNLESS OTHERWISE DIRECTED BY THE COUNCIL DELEGATE. FOOTPATH CROSS FALL TO BE MAXIMUM 2% AND MINIMUM 1%. MAXIMUM LONGITUDINAL GRADE OF 5%. SEEK APPROVAL FROM COUNCIL DELEGATE FOR FALLS OUTSIDE OF THIS RANGE.
 - MATCH NEW PAVEMENT NEATLY AND FLUSH WITH EXISTING.
 - CONTRACTOR TO SUPPLY AND LAY TURF TO AREA AFFECTED BY PROPOSED WORKS OR AS DIRECTED BY THE COUNCIL DELEGATE.
 - THE SPECIES OF TURF TO BE "SOFT LEAF SHADEMASTER BUFFALO" UNLESS DIRECTED OTHERWISE
 - THE TURF SHOULD BE PLACED ON A MINIMUM 100mm DEEP LAYER OF IMPORTED TURF UNDERLAY TOPSOIL
 - SUBSOIL SHOULD BE CULTIVATED TO A MINIMUM DEPTH OF 100mm
 - IRRIGATE THE TURF TWICE A WEEK FOR 12 WEEKS
 - FOR TURFING NOTES REFER TO WAVERLEY COUNCIL STANDARD DRAWING R18.
 - ANY DISRUPTION TO EXISTING NATURE STRIPS OR PLANTED BEDS WITHIN COUNCIL LAND TO BE REINSTATED AS PER EXISTING. SEEK APPROVAL FROM COUNCIL DELEGATE FOR CHANGES TO PLANT SPECIES. EDGING OR PAVING TO NATURE STRIPS REQUIRES APPROVAL FROM THE COUNCIL DELEGATE.
 - ALL DIMENSIONS ARE IN MILLIMETERS UNLESS OTHERWISE SHOWN.

ISSUE	ISSUE DESCRIPTION	DATE	DRN	DES	VER	ISSUE	ISSUE DESCRIPTION	DATE	DRN	DES	VER
A	ORIGINAL ISSUE	11/10/24	AM	AM	NZ						

		SURVEYED BY: N/A DATE: N/A COORDINATION: N/A DATUM: N/A	CIVIL DESIGN, MAJOR PROJECTS Level 1, 87-89 Oxford Street, Bondi Junction, NSW, 2022 PO Box 9, Bondi Junction NSW 1555 Tel: (02) 9083 8000 Email: info@waverley.nsw.gov.au Web: www.waverley.nsw.gov.au	APPROVED: DATE SIGNED: SCALE AS SHOWN @ A3: PLAN: LONG-SECTION VERT: - CROSS-SECTION VERT: -	Project Name: STANDARD DRAWING - ROADS - R4 Drawing Title: ADJOINING PROPERTY CONCRETE DRIVEWAY AND LAYBACK	PROJ No: WC STD DRW TRIM No: XXXX Drawing No: R4 Issue: A
--	--	--	--	--	--	--