

REINSTATE NATURE STRIP/ TURF AS DIRECTED BY COUNCIL DELEGATE. REFER TO NOTE 16 FOR SPECIFICATIONS

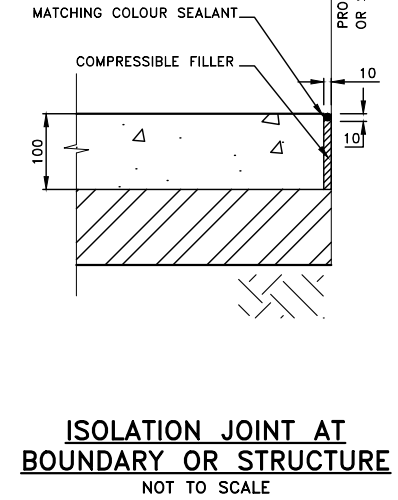

PROVIDE FULL DEPTH ISOLATION JOINT WHERE NEW FOOTPATH ABUTS AGAINST THE KERB/PROPERTY BOUNDARY OR ANOTHER STRUCTURE

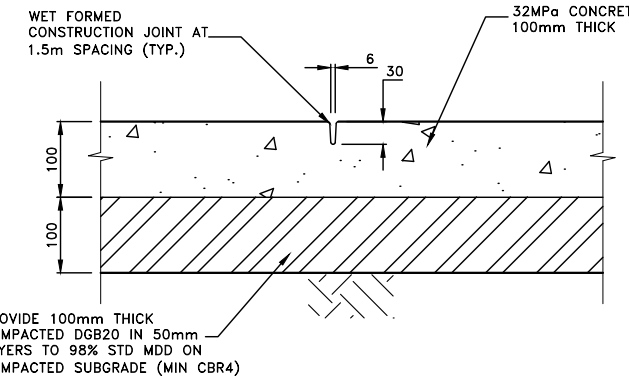
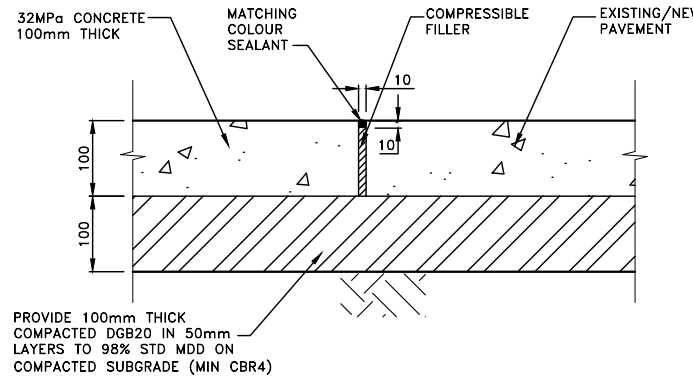
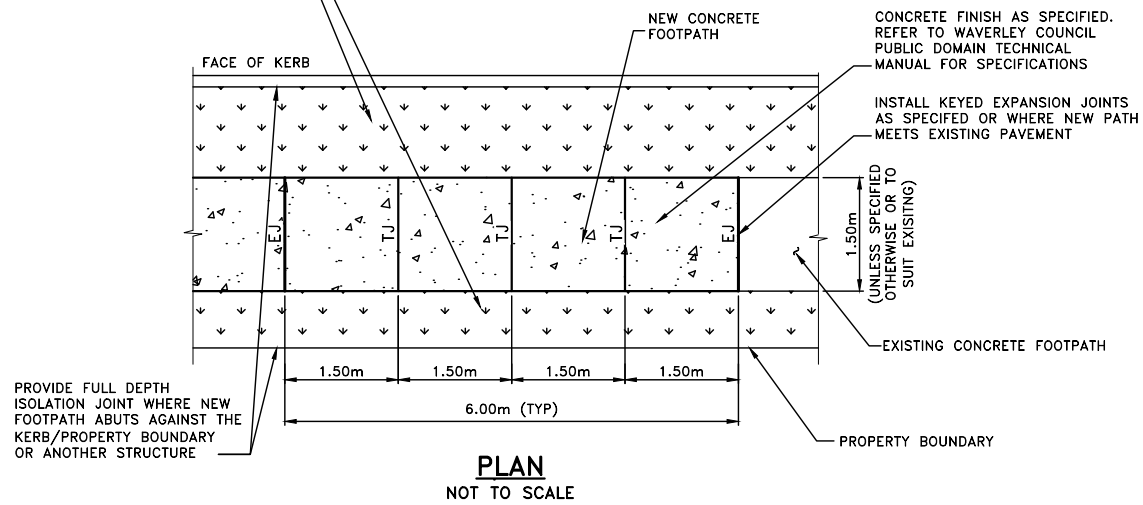
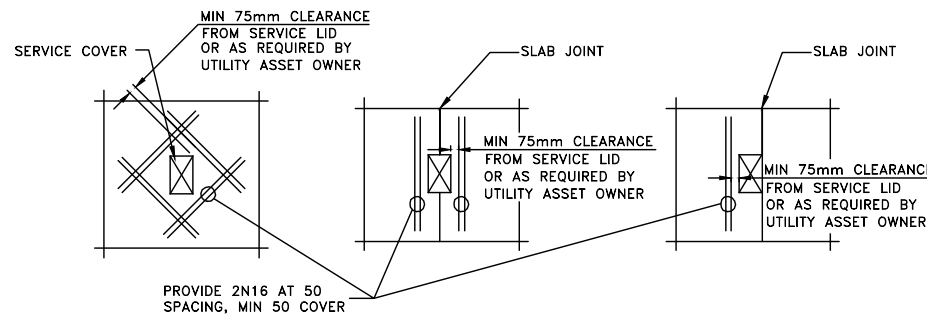
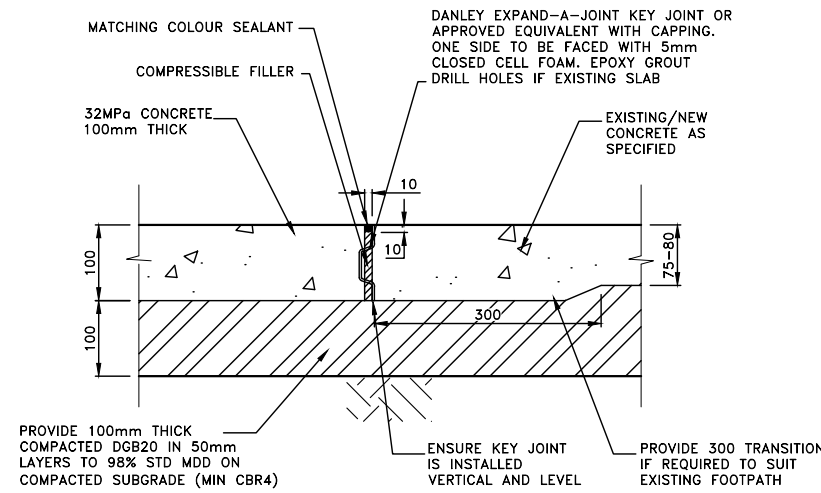
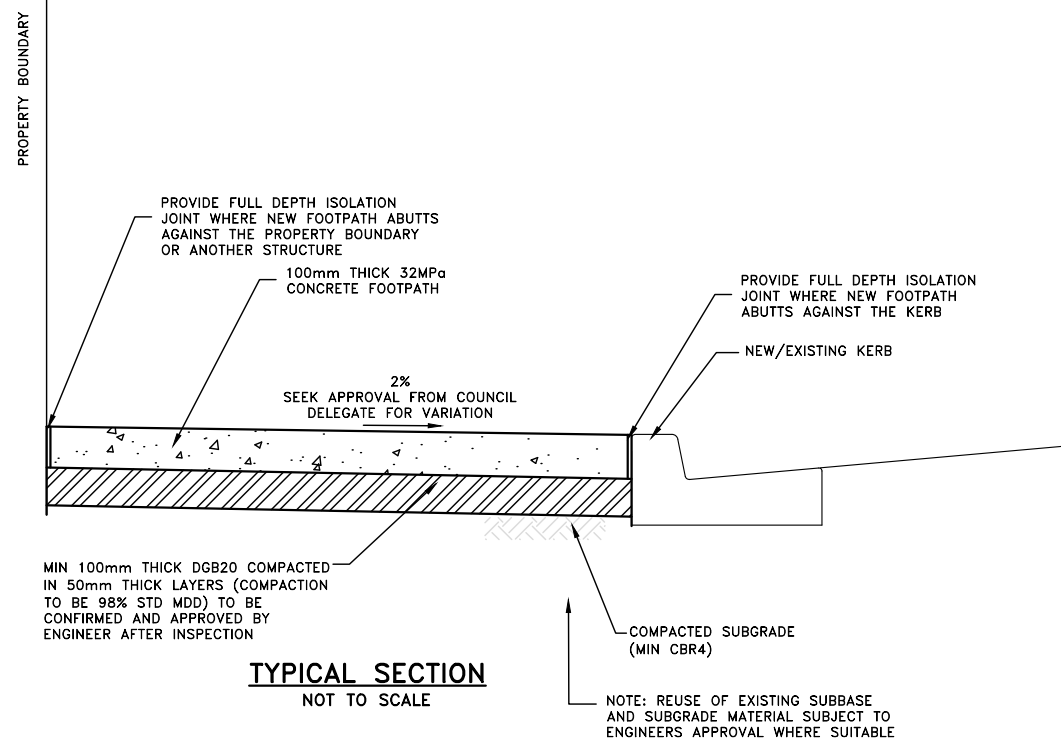

**NOTE**  
ANY CONSTRUCTION WITHIN THE PUBLIC DOMAIN REQUIRES COUNCIL APPROVAL. NON-APPROVED WORKS AND STRUCTURES MAY BE REQUIRED TO BE REMOVED AND THE EXISTING REINSTATED AT THE CONTRACTORS OR DEVELOPERS COST

**LEGEND**  
TJ TOOL JOINT  
EJ EXPANSION JOINT  
IJ ISOLATION JOINT

**NOTE**  
REFER TO WAVERLEY COUNCIL PUBLIC DOMAIN TECHNICAL MANUAL FOR FURTHER FOOTPATH PAVEMENT SPECIFICATIONS AND DETAILS

**NOTES**

- THE WORKS SHALL COMPLY WITH THE CURRENT AND RELEVANT AUSTRALIAN STANDARDS AND TNSW TECHNICAL DIRECTIONS AND GUIDELINES, UNLESS INSTRUCTED OTHERWISE BY THE COUNCIL DELEGATE.
- CONCRETE TO BE OF 32MPa COMPRESSIVE STRENGTH AT 28 DAYS. UNLESS SPECIFIED OTHERWISE, AGGREGATE TO BE BLUEMETAL 10mm TO 14mm.
- CONCRETE TO BE FINISHED AS PER THE SPECIFICATIONS IN WAVERLEY COUNCIL PUBLIC DOMAIN TECHNICAL MANUAL, OR AS APPROVED BY THE COUNCIL DELEGATE.
- LEVEL AT BUILDING ALIGNMENT IS TO COMPLY WITH LEVELS ISSUED IN THE DEVELOPMENT CONSENT, UNLESS OTHERWISE STATED BY THE COUNCIL DELEGATE.
- LEVELS FOR REINSTATEMENT WORKS TO MATCH EXISTING, UNLESS INSTRUCTED OTHERWISE BY THE COUNCIL DELEGATE.
- FOOTPATH CROSS FALL TO BE MAXIMUM 2% AND MINIMUM 1%. SEEK APPROVAL FROM COUNCIL DELEGATE FOR FALLS OUTSIDE OF THIS RANGE.
- MAXIMUM LONGITUDINAL GRADE OF 5%, UNLESS DIRECTED OTHERWISE BY COUNCIL DELEGATE.
- EXCAVATION ON FOOTPATHS SHALL BE FROM EXISTING JOINTS IN THE PAVEMENT IF AVAILABLE, OR SAWN ALONG ALL EDGES.
- CONTRACTOR TO OBTAIN & LOCATE ALL SERVICES PRIOR TO WORKS COMMENCING. UTILITY SERVICE COVERS ARE TO BE ADJUSTED TO SUIT DESIGN FINISHED SURFACE LEVELS. UTILITY COVERS TO BE CLASS D OR EQUIVALENT, OR AS SPECIFIED BY UTILITY ASSET OWNER.
- CONTRACTOR TO ENSURE A 500x500mm EXCLUSION ZONE IS PROVIDED AROUND ALL POWER POLES. NO CONCRETE TO BE POURED IN EXCLUSION ZONE. EXCLUSION ZONE TO BE FILLED WITH ASPHALT COLD MIX ONLY.
- EXISTING PLAQUES OR STATE SURVEY MARKERS ARE NOT TO BE REMOVED PRIOR TO CONSULTING WITH THE COUNCIL DELEGATE.
- PROTECT ALL EXISTING TREES AND TREE ROOTS. NOTIFY THE COUNCIL DELEGATE AND TREE OFFICER PRIOR TO PRUNING.
- KEYED EXPANSION JOINTS TO BE INSTALLED WHERE ADJACENT TREES OR TREE ROOTS, AND AS DIRECTED BY THE COUNCIL DELEGATE.
- COUNCIL'S DELEGATE TO INSPECT FOR ALL UNSOUND AREAS BEFORE POURING CONCRETE PAVEMENT. WEAK SECTIONS ARE TO BE IDENTIFIED AND RECTIFIED TO A NOMINAL THICKNESS OF 200mm WITH DGB20 BEFORE RECOMPACTING IN ACCORDANCE TO TYPICAL CROSS-SECTION. UNLESS SPECIFIED, SEALANT TO BE SILKAFLEX PRO, OR APPROVED EQUIVALENT.
- INSPECTIONS ARE REQUIRED AT THE FOLLOWING STAGES AND AS OTHERWISE DIRECTED BY THE COUNCIL DELEGATE. DO NOT CONTINUE UNTIL APPROVAL RECEIVED FROM COUNCIL DELEGATE.

- CONCRETE WORKS**
- SUBGRADE TRIMMED AND CONSOLIDATED.
  - EXCAVATION COMPLETED, FORMWORK AND REINFORCEMENT SET.
  - CONCRETE FORMED AND CURED.
- PROVIDE EXPANSION JOINTS AS APPROPRIATE BUT SPACED NOT MORE THAN 6m AND TOOL JOINTS EVERY 1.5m, OR AS SPECIFIED. JOINTS SHALL BE STRAIGHT, CONTINUOUS AND NORMAL TO BOUNDARIES AND EDGES. PROVIDE FULL DEPTH EXPANSION JOINTS TO BOUNDARIES, STRUCTURES, KERBS, EDGES AND THE LIKE.
  - CONTRACTOR TO SUPPLY AND LAY TURF TO AREA AFFECTED BY PROPOSED WORKS OR AS DIRECTED BY THE COUNCIL DELEGATE.
    - THE SPECIES OF TURF TO BE "SOFT LEAF SHADEMASTER BUFFALO" UNLESS DIRECTED OTHERWISE
    - THE TURF SHOULD BE PLACED ON A MINIMUM 100mm DEEP LAYER OF IMPORTED TURF UNDERLAY TOPSOIL
    - SUBSOIL SHOULD BE CULTIVATED TO A MINIMUM DEPTH OF 100mm
    - IRRIGATE THE TURF TWICE A WEEK FOR 12 WEEKS, OR AS INSTRUCTED BY THE COUNCIL DELEGATE
  - FOR TURFING NOTES REFER TO WAVERLEY COUNCIL STANDARD DRAWING R18.
  - PROPERTY STORMWATER OUTLET TO BE 125x75x4 RHS, OR TO SUIT EXISTING, MAINTAINING GRAVITY TO FALL TO K&G. INVERT OF OUTLET TO BE LEVEL WITH INVERT OF GUTTER AND MIN 200mm FROM END OF DRIVEWAY OR KERB RAMP LAYBACK.
  - MATCH NEW PAVEMENT NEATLY AND FLUSH WITH EXISTING.
  - ALL DIMENSIONS ARE IN MILLIMETERS UNLESS OTHERWISE SHOWN.

										<p>SURVEYED BY: N/A DATE: N/A COORDINATION: N/A DATUM: N/A</p>										<p>CIVIL DESIGN, MAJOR PROJECTS Level 1, 87-89 Oxford Street, Bondi Junction, NSW, 2022 PO Box 9, Bondi Junction NSW 1555 Tel: (02) 9083 8000 Email: info@waverley.nsw.gov.au Web: www.waverley.nsw.gov.au</p>										<p>APPROVED: _____ DATE SIGNED: _____ SCALE AS SHOWN @ A3: PLAN: _____ LONG-SECTION: _____ VERT: _____</p>										<p>Project Name: <b>STANDARD DRAWING - ROADS - R15</b></p> <p>Drawing Title: <b>UNREINFORCED CONCRETE FOOTPATH</b></p>										<p>PROJ No: WC STD DRW</p> <p>TRIM No: XXXX</p> <p>Drawing No: R15</p> <p>Issue: A</p>									
<p>A ORIGINAL ISSUE</p>										<p>11/10/24 AM AM NZ</p>										<p>DATE DRN DES VER</p>										<p>DATE DRN DES VER</p>										<p>DATE DRN DES VER</p>																			
<p>ISSUE ISSUE DESCRIPTION</p>										<p>DATE DRN DES VER</p>										<p>DATE DRN DES VER</p>										<p>DATE DRN DES VER</p>										<p>DATE DRN DES VER</p>																			